

Pan Flute

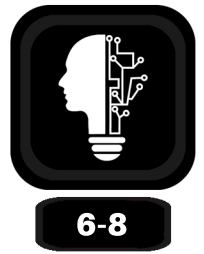

Materials:

- Wide Colorful Plastic Smoothie Straws
- Scissors
- Tape/Hot Glue

Instructions:

1. Cut 5-8 wide straws in different lengths (see below for specific lengths for the different notes)
2. Hot glue/tape the straws side by side starting from the tallest all the way down to the shortest
3. Teach them to rest their lower lip against the tops of the straws and blow across.



Do = 6.8 in

Re = 6.10 in

Mi = 5.3 in

Fa = 4.9 in

So = 4.3 in

La = 3.9 in

Ti = 3.5 in

Do = 3.3 in

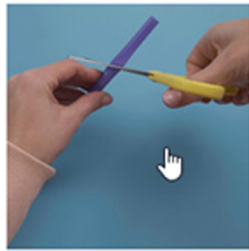

The Science:

As you blow across the top of the straws, a vibration occurs which creates a sound. The pitch of the sound is dictated by the length of the straw. As the length of the straw gets smaller the pitch will go higher.